



# Carbon Rotary Potentiometers - 20 mm size

### Mechanical data

Rotation angle:  $300^{\circ} \pm 5^{\circ}$   
 Operating torque:  $0.4 \div 1.5$  Ncm  
 Possible torque at end stop: 80 Ncm max  
 Possible axial spindle load (5 sec max): 100 N

Packing: 100 pcs

### Electrical data

Rated dissipation @40°C: 0.4 W lin. law  
 0.2 W log. law  
 Limiting element voltage: 500 VDC  
 Resistance tolerance: 100R to 1 M0:  $\pm 20\%$   
 over 1 M0  $\pm 30\%$   
 Resistance range: 100R to 4M7 - lin. law.  
 1K0 to 2M2 - log. law.

Potentiometers are supplied with one nut not mounted

Dimensions in mm

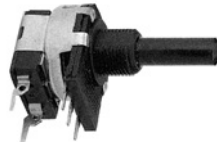
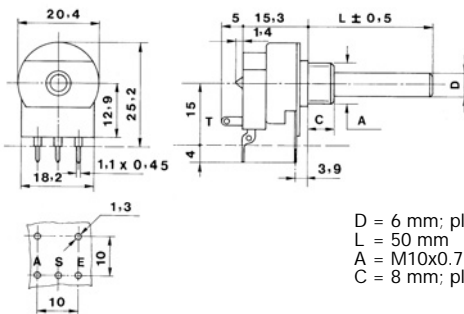

CIP20C IL

D = 6 mm; plastic spindle  
 L = 50 mm  
 A = M10x0.75  
 C = 8 mm; plastic bush

1-pole rotary switch:  
 1.5A - 250 VAC / 5A - 24 VDC

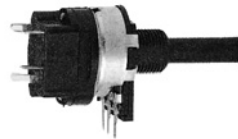
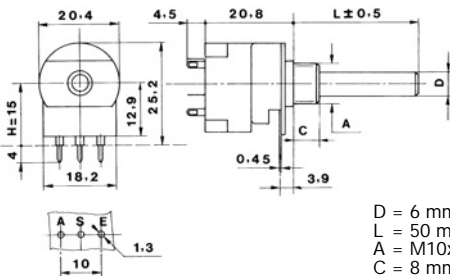

CIP20C 2IFS

D = 6 mm; plastic spindle  
 L = 50 mm  
 A = M10x0.75  
 C = 8 mm; plastic bush

2-pole rotary switch:  
 5A - 250 VDC  
 Mains switch

Approvals: SEMCO, FNIE, VDE, BSI

### Stock Types

Types	Laws	Values										
		1K0	2K2	4K7	10K	22K	47K	100K	220K	470K	1M0	2M2
CIP20C IL	Lin. A	1K0	2K2	4K7	10K	22K	47K	100K	220K	470K	1M0	2M2
	Log. B	1K0	2K2	4K7	10K	22K	47K	100K	220K	470K	1M0	2M2
CIP20C 2IFS	Lin. A	1K0	2K2	4K7	10K	22K	47K	100K	220K	470K	1M0	
	Log. B	1K0	2K2	4K7	10K	22K	47K	100K	220K	470K		

For other technical specifications please visit the internet site [www.radiohm.com](http://www.radiohm.com)>>  
 Products >>Potentiometers & Switches >>Carbon Rotary Potentiometers-20 mm size