

DIL - SURFACE MOUNT

Series DIL - Surface mount
117 1.778 mm, Surface mount

High density DIL sockets for devices featuring 0.07" (1.778 mm) lead spacing

Surface mount Shrinkdip socket with gull wing terminations

Technical specs.:

Insulator: Black glass filled polyester
PCT-GF30-FR
Flammability: UL 94V-O
Sleeve: Brass CuZn36Pb3 (C36000)
Contact: Clip (4 finger): Beryllium copper (C17200)
Accepted pin Ø: 0.40 to 0.56 mm
Insertion force: 2 N typ.
Withdrawal force: 1 N typ.
(polished steel gauge Ø 0.43 mm)
Mechanical life: Min. 100 cycles
Rated current: 1 A
Contact resistance: Max. 10 mΩ
Dielectric strength: Min. 1000 V RMS
Coplanarity SMD term.: Max. 0.10 mm

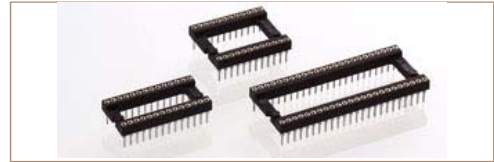
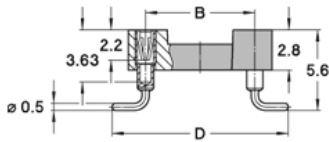

Ordering information RoHS-compliant parts

PP Plating code	Sleeve	Clip
87	Tin	Gold flash
83	Tin	Gold 0.75 µm

General technical specs. ...

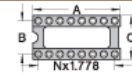

Poles	A	B	C	D	E	See	Order Codes
16	14.6	7.62	10.1				117-PP-316-41-105101
28	25.2	10.16	12.7				117-PP-428-41-105101
30	25.2	10.16	12.7				117-PP-430-41-105101
32	28.8	10.16	12.7				117-PP-432-41-105101
48	43.1	10.16	12.7				117-PP-448-41-105101
20	18.1	15.24	17.64				117-PP-620-41-105101
24	21.7	15.24	17.64				117-PP-624-41-105101
28	25.2	15.24	17.64				117-PP-628-41-105101
40	35.8	15.24	17.64				117-PP-640-41-105101
42	37.7	15.24	17.64				117-PP-642-41-105101
48	43.1	15.24	17.64				117-PP-648-41-105101
52	46.7	15.24	17.64				117-PP-652-41-105101
56	50.2	15.24	17.64				117-PP-656-41-105101
64	57.3	15.24	17.64				117-PP-664-41-105101
68	60.9	15.24	17.64				117-PP-668-41-105101