

SIDE ENTRY



SPECIFICATION:

Current Rating: 3.0A AC,DC
Voltage Rating: 250V AC,DC
Contact Resistance: 20M ohm max
Insulator Resistance: 1,000M ohm Min.
Withstanding Voltage: 1,000V AC/minute
Temperature range: -25°C to +125°C.

MATERIAL:

Insulator: Polyester UL94V-0
Contact: Phosphor Bronze
Finish: Tin Plated

FINISH:

Shell: Tin plated.
Contact: Gold plated on contact area & 100u" Min. Tin/lead plated on soldering end over 50u" Min. Nickel under-plating.
Boardlocks: Tin/lead plated on soldering end over Nickel under-plating.
Threaded Inserts: Nickel plated.

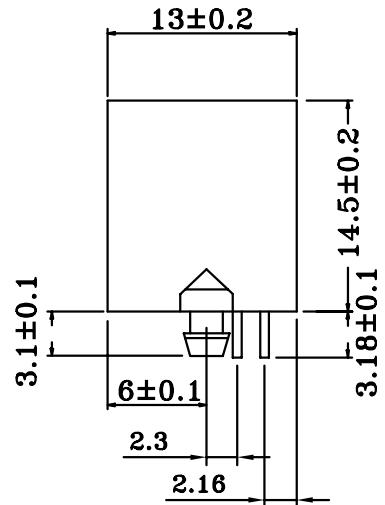
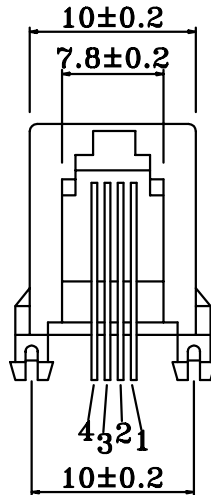
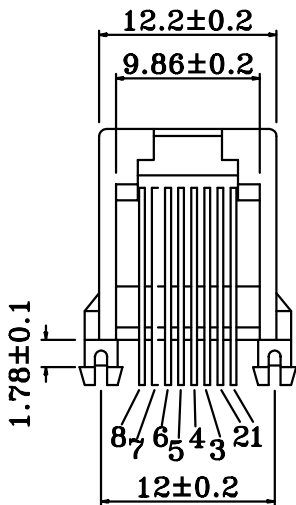
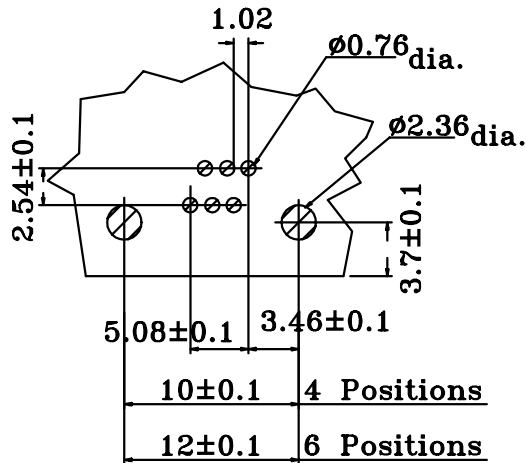

7007-XPXC

